

# SPIRAL REVOLUTION

## Heater for piping

# ほっく管

## Hot tube



Spiral and easy to roll!  
Significant reduction in working time



Easy! Ready to use!  
No need for troublesome wiring



Safe! With temperature controller  
Keep the heater at a constant temperature

Inside the pipe

- Anti-freezing
- Prevention of temperature drop
- Prevention of condensation

## Heater-winding operation time is about **1** minute!

※For the case that the heater length is 1m

Start!



 A flexible and elastic heater.

Start winding



 It can also be attached to straight and elbows.

Winding up



 The spiral shape makes it easy to wind.

Complete!



 Since there is no need for temporary fixing, the winding time can be shortened.



株式会社スリーハイ  
THREE HIGH CO.,LTD.

# All-in-one package that includes a heater, temperature controller, and temperature sensor

ほっぴ管

Hot tube

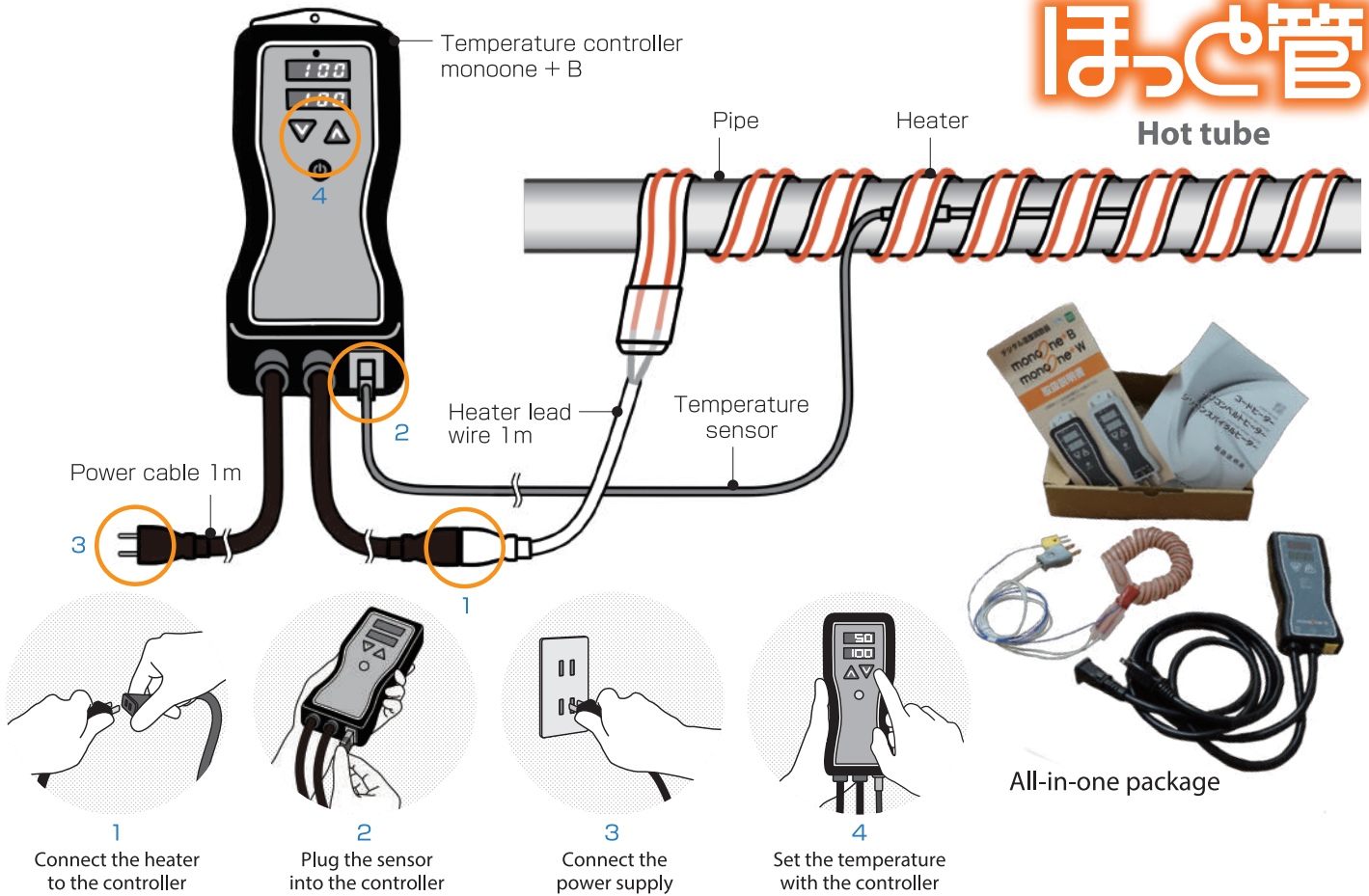

## Heater specifications

The flexible heater allows for complex shapes such as pipes, valves and pumps. It can be easily heated and kept warm.

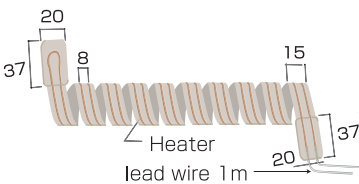

Heater length  
(Dimensions when spiral is extended)

Heater lead wire 1m

Heater  
Silicone rubber  
Cross section

## Temperature sensor specifications

Thermocouple K sheath type (fluororesin coating)

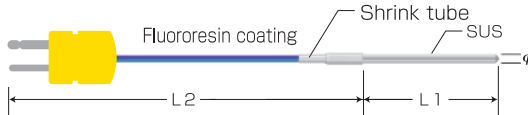

Maximum coating temperature: 260°C, tolerance: Class 1

Product code	$\phi$ (mm)	L1 (m)	L2 (m)
TH-8100-2C	3.2	100	2.0

## Temperature controller specifications

Setting / measured temperature can be displayed at the same time. The set temperature and the measured temperature can be seen at the same time! You can control the temperature safely.

Product name	monoone+B
Power-supply voltage	AC 85V ~ 250V (Single-phase) 50 / 60Hz
Output rating	0.1A ~ 12A (resistive loading)
Input	Thermocouple (K)
Control method	ON/OFF control
Display range	-199 ~ 999°C
Dimensions/weight	165 (vertical) x 70 (horizontal) x 35 (Depth) mm *Excluding protrusions and mounting equipment. About 600g
Power supply cable length	Power supply side 1m (with 100V male outlet plug) Heater side 1 m (with 100V female outlet plug)
Other functions	Error display/Sensor error detection function Overheat prevention setting/Relay-welding detection function High-frequency relay switching detection function Relay switch count monitoring function

Model	Heater length	Voltage	Electric power	Temperature controller	Temperature sensor
SPX-1	1m	100V	50W	monoone+B	TH-8100-2C
SPX-3	3m	100V	150W		
SPX-5	5m	100V	250W		

## [Precautions for use]

- Do not operate above the rated voltage.
- Since it is not waterproof, it cannot be used in places exposed to water.
- Be sure to provide grounding.
- This product does not have an explosion-proof structure, so it cannot be used in an explosion-proof area.
- Do not touch the main body while the power is on. There is a risk of burns.
- Do not use in a flammable gas, pyrophoric gas, or corrosive gas atmosphere.
- Do not disassemble or modify this product.
- Do not pull on the power cable.

株式会社スリーハイ  
THREE HIGH CO.,LTD.

Web: [www.threehigh.com](http://www.threehigh.com)

Mail: [info\\_overseas@threehigh.co.jp](mailto:info_overseas@threehigh.co.jp)

Headquarters/Factory

4-42-16 Higashiyamata, Tsuzuki Ward, Yokohama City,  
Kanagawa 224-0023 JAPAN  
TEL: +81-45-590-5561 FAX: +81-45-590-5571

